

## Panel mounting frames - VS-08-SET-MOD-1-R/5-BU-BU/SD-F - 1658833

Please be informed that the data shown in this PDF Document is generated from our Online Catalog. Please find the complete data in the user's documentation. Our General Terms of Use for Downloads are valid (<http://phoenixcontact.com/download>)



RJ45 panel mounting frame, IP67, for round panel cutout, with grommet, with thread and union nut, with RJ45 socket insert, CAT5e, socket on socket, with protective cover, flat design



**Ethernet**

### Key commercial data

Packing unit	1 pc
Weight per Piece (excluding packing)	28.6 GRM
Custom tariff number	85369010
Country of origin	Germany

### Technical data

Product type	Panel mounting frame
Type	RJ45, IP67, version 6

### Classifications

#### eCl@ss

eCl@ss 4.0	272607xx
eCl@ss 4.1	27260701
eCl@ss 5.0	27260701
eCl@ss 5.1	27260701
eCl@ss 6.0	27260708
eCl@ss 7.0	27440312
eCl@ss 8.0	27440312

#### ETIM

ETIM 3.0	EC001121
ETIM 4.0	EC001121

# Panel mounting frames - VS-08-SET-MOD-1-R/5-BU-BU/SD-F - 1658833

## Classifications

### ETIM

ETIM 5.0	EC002310
----------	----------

### UNSPSC

UNSPSC 6.01	31261501
UNSPSC 7.0901	31261501
UNSPSC 11	31261501
UNSPSC 12.01	31261501
UNSPSC 13.2	31261501

## Drawings

Dimensioned drawing

RJ45 panel mounting frame, IP67

Dimensioned drawing

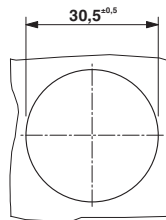

Panel cutout

Dimensioned drawing

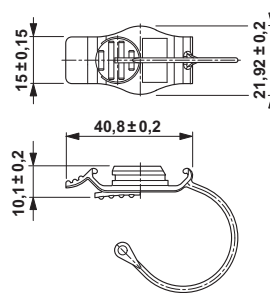

Protective cover, IP67