

INTERCONNECTS

SERIES 329, 340, 414, 429 • 2,54 GRID SURFACE MOUNT HEADERS AND SOCKETS • SINGLE AND DOUBLE ROW STRIPS

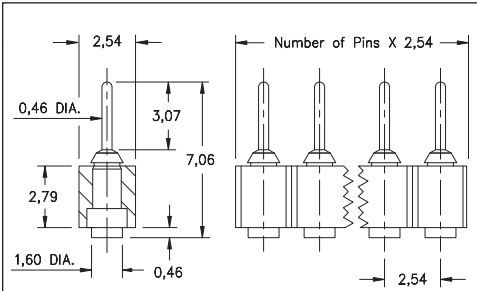

FIG. 1

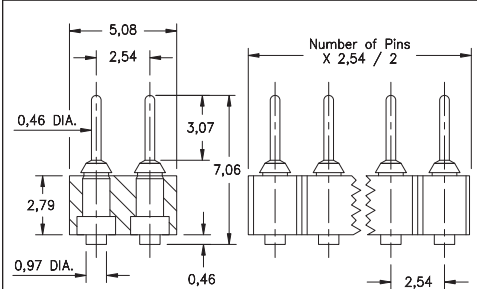

FIG. 2

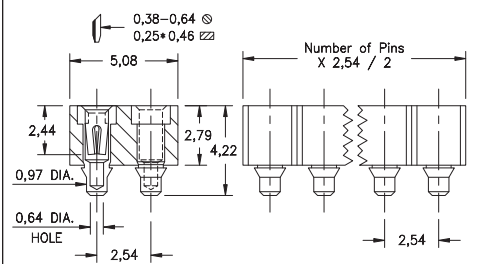

FIG. 3

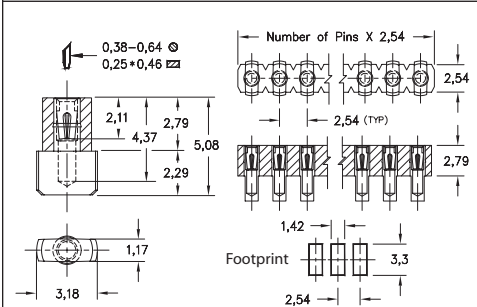
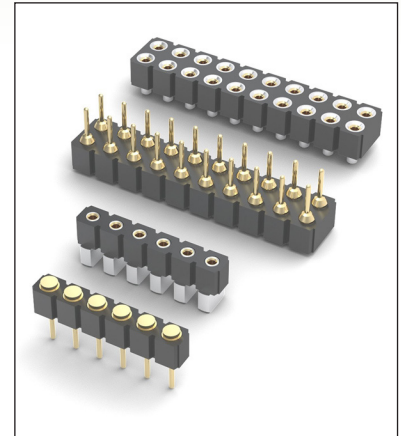

FIG. 4

Coplanarity 0.13. For pin counts >10 positions, consult Technical Support.

- Series 329 and 429 pin interconnects feature space saving, pad style SMT termination using MM #2956-X pins. See page 218 for details
- Series 429 and 414 combine for a mated height of 8,20
- Series 340 and 414 surface mount sockets use MM #4078 and #1434 receptacles. See pages 162 and 167 for details
- Series 340 and 414 receptacles use Hi-Rel, 4-finger BeCu #30 contacts rated at 3 amps. Receptacles accept 0,38 - 0,64 diameter pins See page 253 for details
- Insulators are high temperature thermoplastic, suitable for all soldering operations



ORDERING INFORMATION

FIG. 1	Series 329...560	Single Row Surface Mount Pin Header				
			329-10-1	-00-560000		
		Specify number of pins		02-64		
FIG. 2	Series 429...560	Double Row Surface Mount Pin Header				
			429-10-2	-00-560000		
		Specify number of pins		04-72		
SPECIFY PLATING CODE XX=			10			
Pin Plating			0,25µm Au			

FIG. 3	Series 414...117	Double Row Surface Mount Socket				
			414-XX-2	-41-117000		
		Specify number of pins		04-72		
FIG. 4	Series 340...780	Single Row Surface Mount Socket				
			340-XX-1	-30-780100		
		Specify number of pins		02-64		
SPECIFY PLATING CODE XX=				99	41	43
Sleeve (Pin)				5,08µm Sn/Pb	5,08µm Sn	5,08µm Sn
Contact (Clip)				2,54µm Sn/Pb	0,25µm Au	0,76µm Au
					2,54µm Sn	

