

MATERIAL NUMBER	ENGINEERING NUMBER	STUD SIZE	*S*
191640445	SA-215-04	4	.119/3.02
191640446	SA-215-06	6	.146/3.70
191640443	SA-215-08	8	.173/4.39

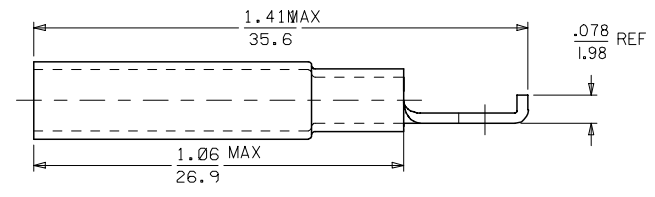
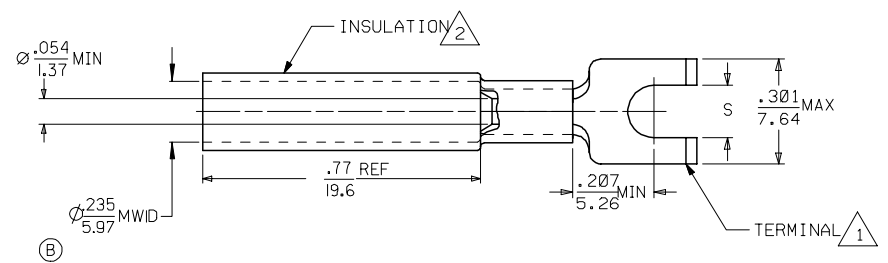

SALES DRAWING

NOTES:

1. TERMINAL MATERIAL: COPPER
PLATING: TIN.
2. INSULATION MATERIAL: HEAT SHRINKABLE NYLON TUBING
W/ HOT-MELT ADHESIVE INNER LINER
COLOR: RED
3. MWID = MAXIMUM WIRE INSULATION DIAMETER.

CHANGED MWID EC NO: ETC2006-0154 DRAWN BY: ASAYDEH CHKD: JLOMASTRO APPR: JPAMLICK	DESCRIPTION 2005/12/21 2005/12/21 2005/12/21	QUALITY SYMBOLS ▽=0 ▽=0	GENERAL TOLERANCES (UNLESS SPECIFIED)	DIMENSION STYLE IN/MM	SCALE ---	DESIGN UNITS INCH	THIRD ANGLE PROJECTION																											
		<table border="1"> <thead> <tr> <th></th> <th>mm</th> <th>INCH</th> </tr> </thead> <tbody> <tr> <td>4 PLACES</td> <td>± ---</td> <td>± ---</td> </tr> <tr> <td>3 PLACES</td> <td>± ---</td> <td>± ---</td> </tr> <tr> <td>2 PLACES</td> <td>± ---</td> <td>± ---</td> </tr> <tr> <td>1 PLACE</td> <td>± ---</td> <td>± ---</td> </tr> </tbody> </table>		mm	INCH	4 PLACES	± ---	± ---	3 PLACES	± ---	± ---	2 PLACES	± ---	± ---	1 PLACE	± ---	± ---	<table border="1"> <thead> <tr> <th>DRAWN BY</th> <th>DATE</th> <th>TITLE</th> </tr> </thead> <tbody> <tr> <td>ASAYDEH</td> <td>05/12/13</td> <td rowspan="3">FLANGED SPADE TONGUE PERMA-SEAL 22-18 AWG</td> </tr> <tr> <th>CHECKED BY</th> <th>DATE</th> </tr> <tr> <td>JLOMASTRO</td> <td>05/12/13</td> </tr> <tr> <th>APPROVED BY</th> <th>DATE</th> <td rowspan="2">MOLEX INCORPORATED</td> </tr> <tr> <td>RDEROSS</td> <td>05/12/13</td> </tr> </tbody> </table>	DRAWN BY	DATE	TITLE	ASAYDEH	05/12/13	FLANGED SPADE TONGUE PERMA-SEAL 22-18 AWG	CHECKED BY	DATE	JLOMASTRO	05/12/13	APPROVED BY	DATE	MOLEX INCORPORATED	RDEROSS	05/12/13	MATERIAL NO.
	mm	INCH																																
4 PLACES	± ---	± ---																																
3 PLACES	± ---	± ---																																
2 PLACES	± ---	± ---																																
1 PLACE	± ---	± ---																																
DRAWN BY	DATE	TITLE																																
ASAYDEH	05/12/13	FLANGED SPADE TONGUE PERMA-SEAL 22-18 AWG																																
CHECKED BY	DATE																																	
JLOMASTRO	05/12/13																																	
APPROVED BY	DATE	MOLEX INCORPORATED																																
RDEROSS	05/12/13																																	
DRAFT WHERE APPLICABLE MUST REMAIN WITHIN DIMENSIONS			SEE CHART	SD-19164-024	1 OF 1																													
THIS DRAWING CONTAINS INFORMATION THAT IS PROPRIETARY TO MOLEX INCORPORATED AND SHOULD NOT BE USED WITHOUT WRITTEN PERMISSION																																		