

THIS DRAWING IS UNPUBLISHED. RELEASED FOR PUBLICATION
 © COPYRIGHT BY TYCO ELECTRONICS CORPORATION. ALL RIGHTS RESERVED.

LOC	DIST	REVISIONS					
AD	00	P	LTR	DESCRIPTION	DATE	DWN	APVD
		B1		ECO-06-18263	02AUG06	MB	JO
		B2		REVISED PER ECO-09-021510	14SEP09	KK	AEG

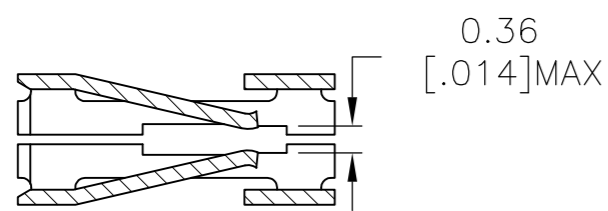
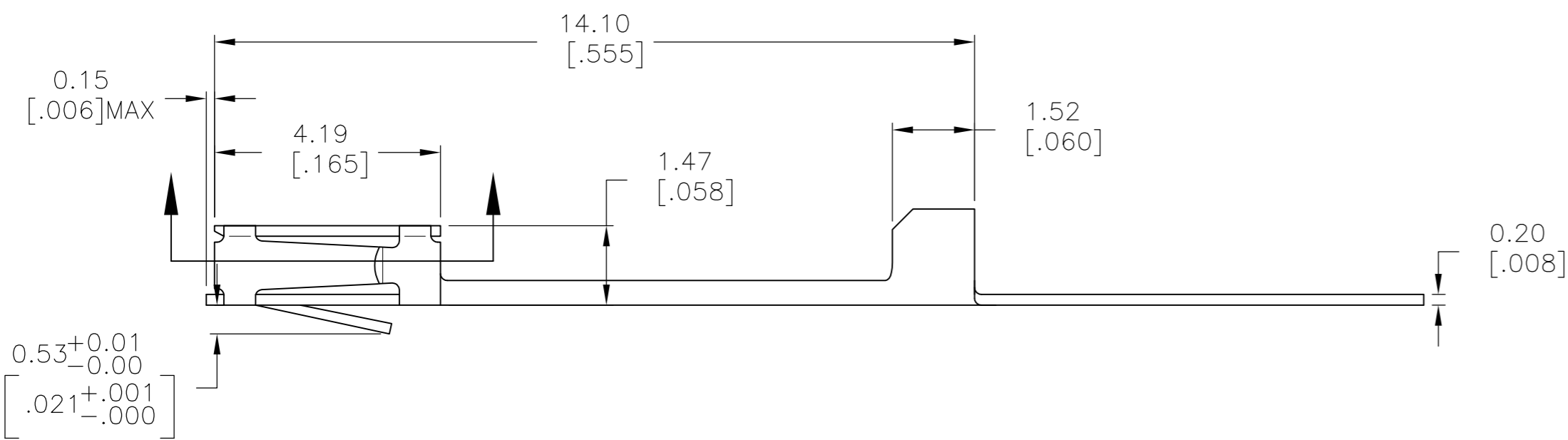
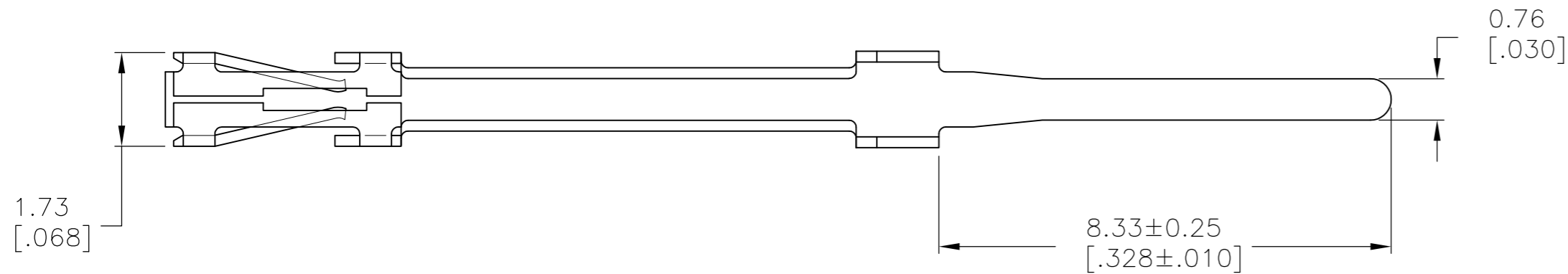

- 1 PHOSHOR BRONZE
- 2 GOLD FLASH ENTIRE POST RCPT END, 0.00076 [.000030] GOLD IN CONTACT AREA, 0.00254-0.00508[.000100-.000200] BRIGHT TIN-LEAD ON SOLDER LEAD, ALL OVER 0.00127[.000050] NICKEL.
- 3 GOLD FLASH ENTIRE POST RCPT END, 0.00076 [.000030] GOLD IN CONTACT AREA, 0.00254-0.00508[.000100-.000200] MATTE TIN ON SOLDER LEAD, ALL OVER 0.00127[.000050] NICKEL.
- 4 ROHS 2002/95/EC COMPLIANT.
- 5 OBSOLETE PARTS: OBSOLETE CIS STREAMLINING PER D.RENAUD/D.SINISI

5	OBSOLETE	3	4	5	535602-1
		2			535602-1
		FINISH		PART NUMBER	

THIS DRAWING IS A CONTROLLED DOCUMENT.		DWN	M.BINNER	02AUG06	Tyco Electronics Corporation Harrisburg, PA 17105-3608		
DIMENSIONS: mm [INCHES]		CHK	J.OLSON	02AUG06	NAME CONTACT, MOD IV, RECEPTACLE LOOSE PIECE		
TOLERANCES UNLESS OTHERWISE SPECIFIED:		APVD	J.OLSON	02AUG06	PRODUCT SPEC	-	
0 PLC ± -		APPLICATION SPEC	-				
1 PLC ± -		WEIGHT	-				
2 PLC ± 0.13[.005]		SCALE	A2		CAGE CODE	00779	
3 PLC ± -		FINISH	SEE TABLE				
4 PLC ± -		SIZE	A2		DRAWING NO	C=535602	
4 ANGLES ± -		RESTRICTED TO	-				
MATERIAL 1		SCALE	10:1		SHEET	1 of 1	
CUSTOMER DRAWING		REV	B2				

535602

A